

COUPLERS

SPECIAL USE

The H84100 has a rotating head designed to lock at angles within its 180° rotation. This coupler is ideal for greasing multiple points with different angles of engagement. The H84001 has the ability to access the greasing point at a 90° angle and is useful for greasing in areas where access is limited or there is a low clearance to the greasing nipple.

H84100

180° Swivel Hydraulic Coupler
1/8"-27 NPT
3,000 psi

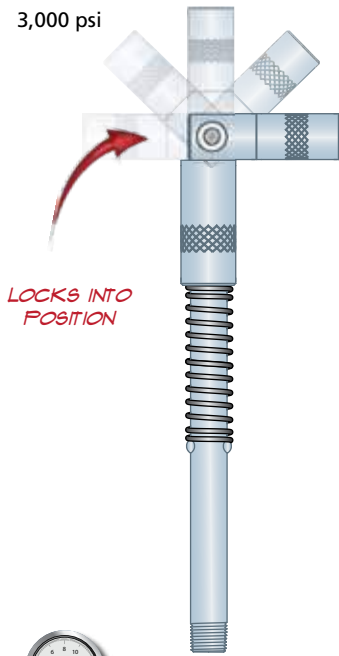

3,000 PSI

Ⓜ 3 JAW CONSTRUCTION
✎ FOR HAND EQUIPMENT

H84150

360° Swivel Hydraulic Coupler
1/8"-27 NPT
7,000 psi

LOCKS INTO POSITION

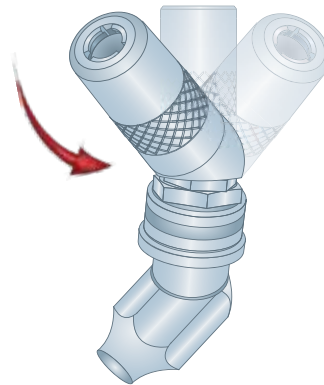

7,000 PSI

Ⓜ 3 JAW CONSTRUCTION
✎ FOR HAND EQUIPMENT

H84001

90° Hydraulic Coupler
1/8"-27 NPT
1,000 psi

PUSH STYLE

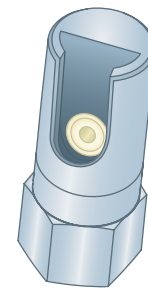

USE FOR LOW CLEARANCE APPLICATIONS

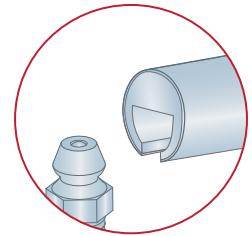

1,000 PSI

✎ FOR HAND EQUIPMENT

Item #	Description	Jaws	Equipment Type	Thread	Working Pressure	Ball Check?
H84100	Hydraulic Coupler - 180° Swivel	3 Jaw	Hand	1/8"-27 NPT	3,000 psi	Yes
H84150	Hydraulic Coupler - 360° Swivel	3 Jaw	Hand	1/8"-27 NPT	7,000 psi	Yes
H84001	Hydraulic Coupler - 90° Push-on	Polyurethane	Hand	1/8"-27 NPT	1,000 psi	No

DESIGN FEATURE

UNS THREADS

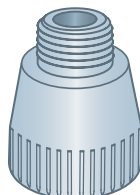

H85000

THE H84400, H84460 AND H84450 BUTTON HEAD COUPLERS POSSESS UNS THREADS AND REQUIRE A THREAD ADAPTER SHOWN HERE.

SEE NEXT PAGE