



COTTERLESS

DESCRIPTION

Cotterless (detent) clevis pins feature a spring-loaded ball bearing for easy one-piece fastening. Typical uses include blind holes or in repetitive-use applications. See also "Detent Pins," page 67.



HOW TO IDENTIFY

1. Verify flat head pin with self-locking ball bearing at opposite end.
2. Measure diameter (A).
3. Measure shank length (G).
4. Find the part in the chart below.

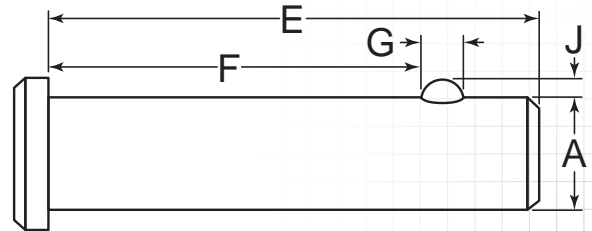

PREFIX MATERIAL/FINISH

CLPCZ = LOW CARBON STEEL, ZINC CLEAR

ADDITIONAL SIZES AND FINISHES MAY BE AVAILABLE UPON REQUEST

ITEM NUMBER	(E) SHANK LENGTH	(F) EFFECTIVE LENGTH
3/16 (.188") (A) Outside Diameter .186/.181"		
(J) Ball Height: .017" .022/.012" (G) Ball Width: .078" (5/64) (E) Tolerance: +.020/-0.000"		
CLPCZ-0187-1000	1.000" (1)	.812" (13/16)
CLPCZ-0187-1500	1.500" (1-1/2)	1.312" (1-5/16)
CLPCZ-0187-2000	2.000" (2)	1.812" (1-13/16)
CLPCZ-0187-2500	2.500" (2-1/2)	2.312" (2-5/16)
CLPCZ-0187-3000	3.000" (3)	2.812" (2-13/16)
1/4 (.250") (A) Outside Diameter .248/.243"		
(J) Ball Height: .036" .041/.031" (G) Ball Width: .125" (1/8) (E) Tolerance: +.020/-0.000"		
CLPCZ-0250-1000	1.000" (1)	.750" (3/4)
CLPCZ-0250-1500	1.500" (1-1/2)	1.250" (1-1/4)
CLPCZ-0250-2000	2.000" (2)	1.750" (1-3/4)
CLPCZ-0250-2500	2.500" (2-1/2)	2.250" (2-1/4)
CLPCZ-0250-3000	3.000" (3)	2.750" (2-3/4)
CLPCZ-0250-3500	3.500" (3-1/2)	3.250" (3-1/4)
CLPCZ-0250-4000	4.000" (4)	3.750" (3-3/4)
CLPCZ-0250-5000	5.000" (5)	4.750" (4-3/4)
5/16 (.313") (A) Outside Diameter .311/.306"		
(J) Ball Height: .047" (3/64) .051/.041" (G) Ball Width: .156" (5/32) (E) Tolerance: +.020/-0.000"		
CLPCZ-0312-1000	1.000" (1)	.625" (5/8)
CLPCZ-0312-1500	1.500" (1-1/2)	1.125" (1-1/8)
CLPCZ-0312-2000	2.000" (2)	1.625" (1-5/8)

ITEM NUMBER	(E) SHANK LENGTH	(F) EFFECTIVE LENGTH
CLPCZ-0312-2500	2.500" (2-1/2)	2.125" (2-1/8)
CLPCZ-0312-3000	3.000" (3)	2.625" (2-5/8)
CLPCZ-0312-3500	3.500" (3-1/2)	3.125" (3-1/8)
CLPCZ-0312-4000	4.000" (4)	3.625" (3-5/8)
3/8 (.375") (A) Outside Diameter .373/.368"		
(J) Ball Height: .051" .056/.047" (G) Ball Width: .188" (3/16) (E) Tolerance: +.020/-0.000"		
CLPCZ-0375-1000	1.000" (1)	.625" (5/8)
CLPCZ-0375-1500	1.500" (1-1/2)	1.125" (1-1/8)
CLPCZ-0375-2000	2.000" (2)	1.625" (1-5/8)
CLPCZ-0375-2500	2.500" (2-1/2)	2.125" (2-1/8)
CLPCZ-0375-3000	3.000" (3)	2.625" (2-5/8)
CLPCZ-0375-3500	3.500" (3-1/2)	3.125" (3-1/8)
CLPCZ-0375-4000	4.000" (4)	3.625" (3-5/8)
1/2 (.500") (A) Outside Diameter .496/.491"		
(J) Ball Height: .059" .064/.054" (G) Ball Width: .250" (1/4) (E) Tolerance: +.020/-0.000"		
CLPCZ-0500-1000	1.000" (1)	.500" (1/2)
CLPCZ-0500-1500	1.500" (1-1/2)	1.125" (1-1/8)
CLPCZ-0500-2000	2.000" (2)	1.500" (1-1/2)
CLPCZ-0500-2500	2.500" (2-1/2)	2.000" (2)
CLPCZ-0500-3000	3.000" (3)	2.500" (2-1/2)
CLPCZ-0500-3500	3.500" (3-1/2)	3.000" (3)
CLPCZ-0500-4000	4.000" (4)	3.500" (3-1/2)
CLPCZ-0500-4500	4.500" (4-1/2)	4.000" (4)
CLPCZ-0500-5000	5.000" (5)	4.500" (4-1/2)