



## SAFETY PIN – HEAVY DUTY

### DESCRIPTION

Same features and design as regular safety pins except with heavier gauge wire and an added coil to provide extra spring tension.

### HOW TO IDENTIFY

1. Verify self-locking wire form with an added coil.
2. Measure wire diameter (A).
3. Measure effective length (B).
4. Find the part in the chart below.

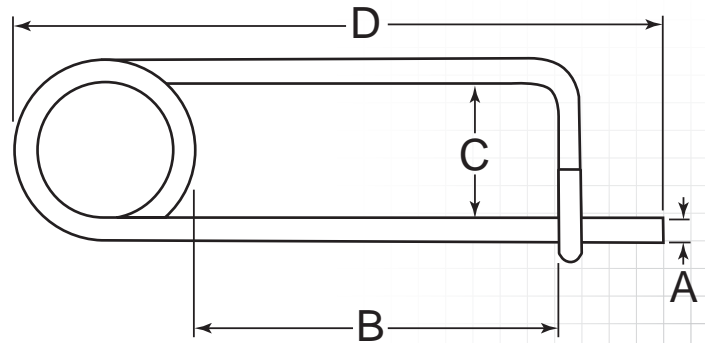
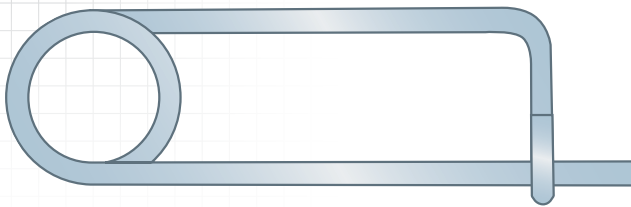

### PREFIX MATERIAL/FINISH

Heavy duty identified by "-H" at end of item number.

**SFP** = HARD DRAWN SPRING WIRE, ZINC CLEAR

**SFP<sub>SS</sub>** = 316 STAINLESS STEEL, PLAIN

Material/finish combinations may not be available in all sizes.

ADDITIONAL SIZES AND FINISHES MAY BE AVAILABLE UPON REQUEST

ITEM NUMBER	(A) WIRE DIAMETER	(B) EFFECTIVE LENGTH	(C) HEIGHT	(D) OVERALL LENGTH
PREFIX-047-0937-H	.047" (3/64)	.938" (15/16)	.375" (3/8)	1.572"
PREFIX-058-1062-H	.058"	1.063" (1-1/16)	.375" (3/8)	1.775"
PREFIX-091-1687-H	.091"	1.688" (1-11/16)	.625" (5/8)	2.763"
PREFIX-120-2750-H	.120"	2.750" (2-3/4)	.875" (7/8)	4.619"
PREFIX-120-2812-H	.120"	2.813" (2-13/16)	.813" (13/16)	4.383"
PREFIX-125-1500-H	.125" (1/8)	1.500" (1-1/2)	.260"	1.832"
PREFIX-148-3750-H	.148"	3.750" (3-3/4)	1.125" (1-1/8)	5.892"
PREFIX-177-3000-H	.177"	3.000" (3)	1.500" (1-1/2)	5.596"
PREFIX-243-5000A-H	.243"	5.000" (5)	1.625" (1-5/8)	8.360"
PREFIX-243-5000B-H	.243"	5.000" (5)	2.250" (2-1/4)	8.860"

### PEOPLE WHO BOUGHT THESE ALSO BOUGHT

TYPE 1



TYPE 2



TYPE 3



TYPE 1



TYPE 2



STEEL TETHERS

Page 128

NYLON TETHERS

Page 128