

THREE-POINT PINS

HUYETT.COM • 785-392-3017

BOX 232 • MINNEAPOLIS, KS • 67467
SALES@HUYETT.COM • FAX 785-392-2845

COIL TENSION – STANDARD DUTY

DESCRIPTION

The coiled design provides a spring resistance that helps maintain locking action in presence of lateral movement.

HOW TO IDENTIFY

1. Verify pin with attached coiled handle wire lock.
2. Measure diameter (A).
3. Measure effective length (C).
4. Find the part in the chart below.

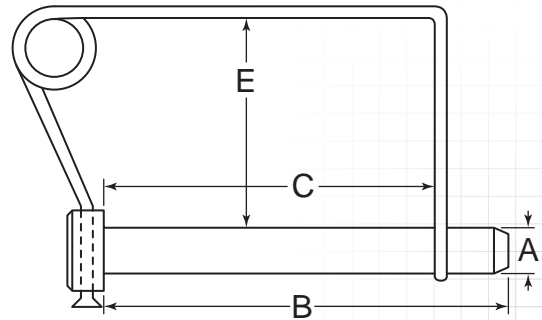
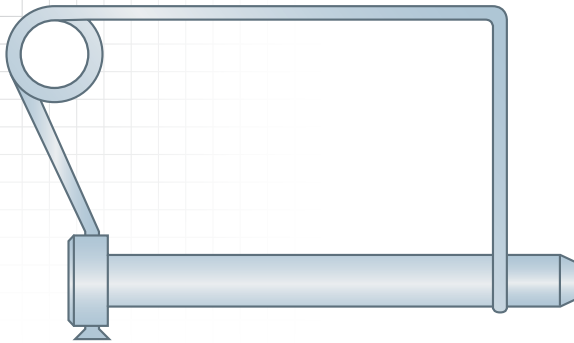

PREFIX MATERIAL/FINISH

SNIC = LOW CARBON STEEL, ZINC CLEAR
SNICS = 300 SERIES STAINLESS STEEL

ADDITIONAL SIZES AND FINISHES MAY BE AVAILABLE UPON REQUEST

ITEM NUMBER	(A) OUTSIDE DIAMETER -.002/-0.007"	(C) EFFECTIVE LENGTH +.020/-0.000"	(E) HEIGHT	(B) SHANK LENGTH
PREFIX-0250-1750	.250" (1/4)	1.750" (1-3/4)	1.500" (1-1/2)	2.250" (2-1/4)
PREFIX-0250-2125	.250" (1/4)	2.125" (2-1/8)	1.500" (1-1/2)	2.625" (2-5/8)
PREFIX-0250-2250	.250" (1/4)	2.250" (2-1/4)	1.500" (1-1/2)	2.750" (2-3/4)
PREFIX-0250-2500	.250" (1/4)	2.500" (2-1/2)	1.500" (1-1/2)	3.000" (3)
PREFIX-0250-3000	.250" (1/4)	3.000" (3)	1.625" (1-5/8)	3.438" (3-7/16)
PREFIX-0250-3500	.250" (1/4)	3.500" (3-1/2)	1.750" (1-3/4)	3.938" (3-15/16)
PREFIX-0250-4000	.250" (1/4)	4.000" (4)	2.000" (2)	4.438" (4-7/16)
PREFIX-0312-2250	.313" (5/16)	2.250" (2-1/4)	1.500" (1-1/2)	2.750" (2-3/4)
PREFIX-0312-2500	.313" (5/16)	2.500" (2-1/2)	1.500" (1-1/2)	3.000" (3)
PREFIX-0312-2750	.313" (5/16)	2.750" (2-3/4)	1.500" (1-1/2)	3.250" (3-1/4)
PREFIX-0312-3000	.313" (5/16)	3.000" (3)	1.563" (1-9/16)	3.438" (3-7/16)
PREFIX-0312-3500	.313" (5/16)	3.500" (3-1/2)	1.750" (1-3/4)	3.938" (3-15/16)
PREFIX-0312-4000	.313" (5/16)	4.000" (4)	2.000" (2)	4.438" (4-7/16)
PREFIX-0375-2250	.375" (3/8)	2.250" (2-1/4)	1.500" (1-1/2)	2.750" (2-3/4)
PREFIX-0375-2500	.375" (3/8)	2.500" (2-1/2)	1.500" (1-1/2)	3.000" (3)
PREFIX-0375-3000	.375" (3/8)	3.000" (3)	1.500" (1-1/2)	3.438" (3-7/16)
PREFIX-0375-3500	.375" (3/8)	3.500" (3-1/2)	1.750" (1-3/4)	3.938" (3-15/16)
PREFIX-0375-4000	.375" (3/8)	4.000" (4)	2.000" (2)	4.438" (4-7/16)
	-.002/.010"	+.020/-0.000"		
PREFIX-0500-3500	.500" (1/2)	3.500" (3-1/2)	2.500" (2-1/2)	3.938" (3-15/16)
	-.004/.009"	+.125/-0.000"		
PREFIX-0625-4000	.625" (5/8)	4.250" (4-1/4)	3.000" (3)	4.875" (4-7/8)
PREFIX-0750-4000	.750" (3/4)	4.000" (4)	2.000" (2)	5.750" (5-3/4)
PREFIX-0750-6000	.750" (3/4)	6.000" (6)	3.000" (3)	7.313" (7-5/16)

FOR DETAILED SPECIFICATIONS AND TOLERANCES, VISIT HUYETT.COM.
Prices, materials, dimensions, tolerances, designs, and grades subject to change without notice. © 2015 G.L. Huyett