

# THREE-POINT PINS

HUYETT.COM • 785-392-3017

BOX 232 • MINNEAPOLIS, KS • 67467  
SALES@HUYETT.COM • FAX 785-392-2845

## SNAP – SINGLE-WIRE

### DESCRIPTION

Single-wire snap pins are intended for standard duty applications. These pins are self-locking requiring no mating part.

### HOW TO IDENTIFY

1. Verify pin with attached round or square handle single-wire lock.
2. Measure diameter (A).
3. Measure effective length (C).
4. Find the part in the chart below.

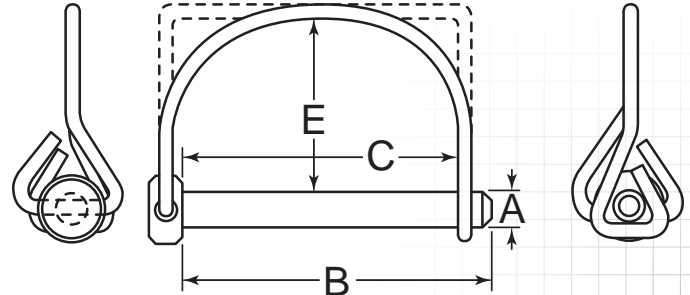
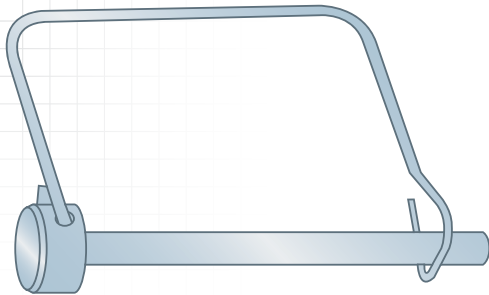

### PREFIX MATERIAL/FINISH

SNIP = LOW CARBON STEEL, ZINC CLEAR

ADDITIONAL SIZES AND FINISHES MAY BE AVAILABLE UPON REQUEST

ITEM NUMBER	(A) OUTSIDE DIAMETER -.0021-.007"	(C) EFFECTIVE LENGTH .0001-.250"	(E) HEIGHT	(B) SHANK LENGTH
<b>Round Handle</b>				
SNIP-250-1750R	.250" (1/4)	1.750" (1-3/4)	1.625" (1-5/8)	2.000" (2)
SNIP-312-1750R	.313" (5/16)	1.750" (1-3/4)	1.750" (1-3/4)	2.000" (2)
SNIP-375-1750R	.375" (3/8)	1.750" (1-3/4)	1.500" (1-1/2)	2.000" (2)
<b>Square Handle</b>				
SNIP-250-2500S	.250" (1/4)	2.500" (2-1/2)	1.625" (1-5/8)	2.750" (2-3/4)
SNIP-312-2500S	.313" (5/16)	2.500" (2-1/2)	1.750" (1-3/4)	2.750" (2-3/4)
SNIP-312-3500S	.313" (5/16)	3.500" (3-1/2)	1.750" (1-3/4)	3.750" (3-3/4)
SNIP-375-2250S	.375" (3/8)	2.250" (2-1/4)	1.500" (1-1/2)	2.500" (2-1/2)
SNIP-375-2500S	.375" (3/8)	2.500" (2-1/2)	1.500" (1-1/2)	2.750" (2-3/4)
SNIP-375-3000S	.375" (3/8)	3.000" (3)	1.500" (1-1/2)	3.250" (3-1/4)

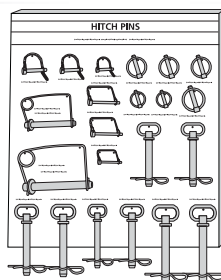

THREE-POINT PIN ASSORTMENT  
AVAILABLE ON PAGE 63

 SINGLE-WIRE SNAP PINS ARE AVAILABLE IN BOTH SQUARE AND ROUND HANDLE

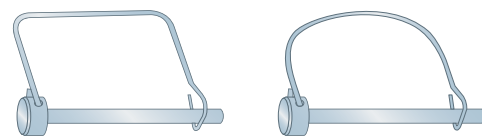

**HUYETT.COM**

FOR DETAILED SPECIFICATIONS AND TOLERANCES, VISIT HUYETT.COM.  
Prices, materials, dimensions, tolerances, designs, and grades subject to change without notice. © 2015 G.L. Huyett